

Model: JL900-Q2/C4/F/16/P/50/Z/W2



**Design Feature**

- Full bore design, quick response, zero leakage
- Anti-fire & static structure, silica sol precision casting, safe & reliable
- The valve meets ISO5211 standard high platform design, ultra long service life
- Bidirectional sealing, bidirectional pressure bearing, automatic Compensation, self-cleaning function
- The valve core adopts L type and T type to meet the requirements of different working conditions

**Model Naming Method**

JL	-900	-Q2	-C4	-F	-16	-P	-50	-Z	-	-W2	-	-
Juliang brand	Electric	3-Way valve	Flange	PTFE	PN	SS304	DN	Standard switch type	Anti-explosion class	-20~150°C	Attachment selection	Attachment selection

**Technical Parameter**

DN	DN15~200mm
Nominal pressure	1.6~2.5Mpa (other pressure standard, please indicate when ordering)
Body material	WCB (C), SS304 (P), SS316 (R)
Sealing material	PTFE (F), PPL (PPL)
Medium temp.	W2:-20~150°C W3:-20~250°C
Connection mode	Flange
Pneumatic actuator	JLAT series, JLAW series, Imported actuator series
Action mode	Double acting, Single acting normally closed, Single acting normally open
Electric actuator	JLA series, JLB series, Imported actuator series
Control mode	Standard switch type, Integral regulating type, Integral switch type, Field bus type

- Note: 1. The valve body can be casted, the form is divided into floating type, fixed type.  
2. Other special sealing materials and special temperature can be selected according to customers' requirements.

**Main component table**

No.	Part Name	No.	Part Name
1	Valve body	12	Nut
2	Bonnet	13	Packing gland
3	Flat cover	14	Wear-proof sleeve
4	Ball	15	Fixed seat
5	Valve seat	16	Filter pressure reducing valve
6	Valve body sealed washer	17	Solenoid valve
7	Bolt	18	Pneumatic actuator
8	Stem	19	Limit switch
9	Thrust washer	20	Anti-explosion electric actuator
10	O type ring	21	Electric actuator
11	V type packing		

- Note: The materials of main parts and sealing ring can be designed and selected according to the actual working conditions or customers' requirements.

**Technical specification**

Design consideration	GB		API	
	Design standard	GB/T 12237	API 608	API 6D
Flange connection	HG/T 20592	ASME B16.5	JIS B2220	
Wall thickness standard	HG/T 26640			
Test, Inspection standard	GB/T 26480		API 598	

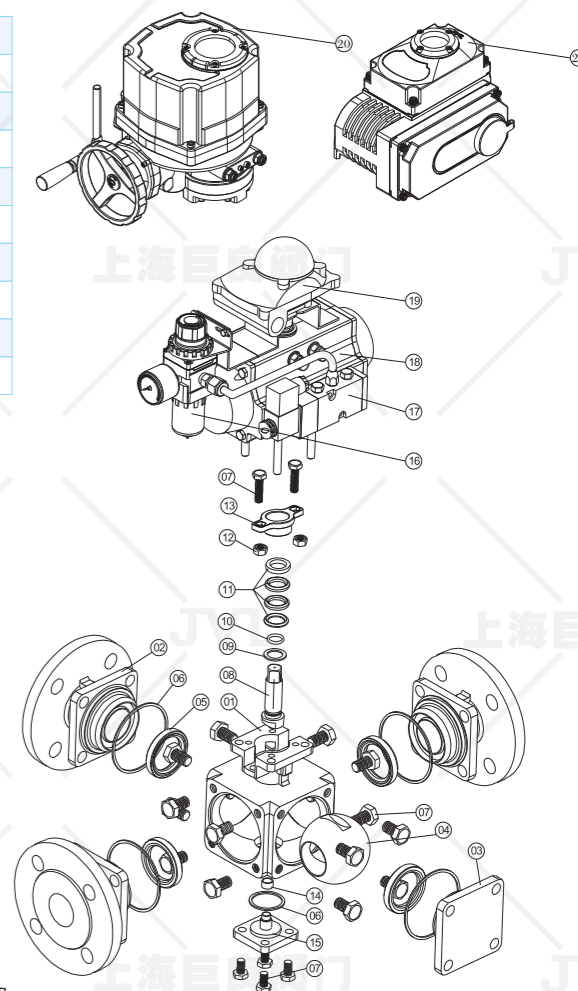

# THREE-WAY FLANGED BALL VALVE

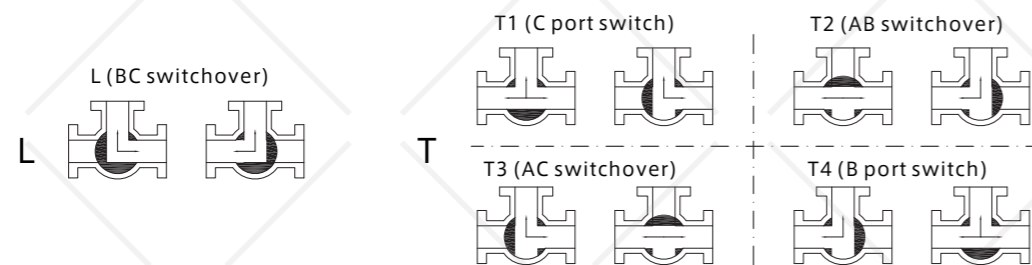
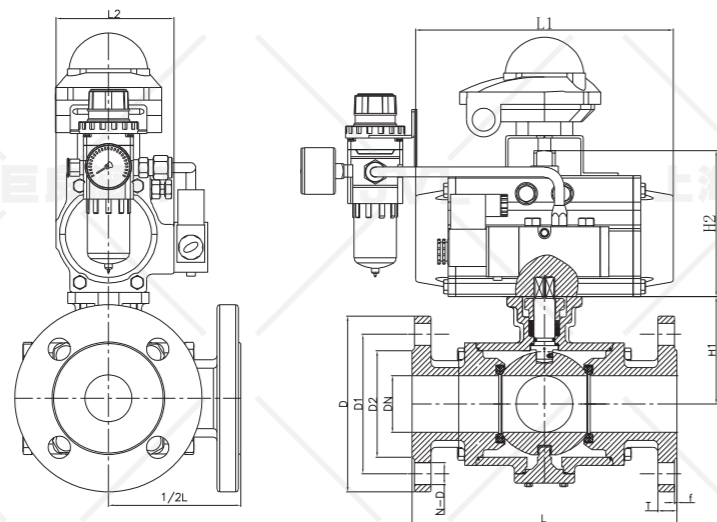

▼ PNEUMATIC OVERALL DIMENSIONS CHART-PN16 ( 16bar )

DN	Overall Dimension					Connection Dimension						Actuator Model
	L	L1	L2	H1	H2	D	D1	D2	T	f	N-D	
15	155	172/185	85/95	65	90/100	95	65	45	16	2	4-14	JLATD63/JLATE75
20	165	185/215	95/105	65	100/110	105	75	58	18	2	4-14	JLATD75/JLATE83
25	181	185/215	95/105	68	100/110	115	85	68	18	2	4-14	JLATD75/JLATE83
32	190	215/265	105/110	79	110/120	140	100	78	18	2	4-18	JLATD83/JLATE92
40	212	265/270	110/125	85	120/142	150	110	88	18	2	4-18	JLATD92/JLATE105
50	232	270/310	125/142	93	142/158	165	125	102	18	2	4-18	JLATD105/JLATE125
65	290	310/400	142/160	121	158/178	185	145	122	18	2	8-18	JLATD125/JLATE140
80	310	310/400	142/160	153	158/178	200	160	138	20	2	8-18	JLATD125/JLATE140
100	350	400/465	160/178	171	178/200	220	180	158	20	2	8-18	JLATD140/JLATE160

●Note: According to different valve torque, different air supply pressure and different actual working conditions, select the matched actuator, and its relevant dimensions change accordingly.

▼ Attachment selection

Solenoid valve	3/2, 5/2, single electric control and double electric control, please indicate when ordering
Filter pressure reducing valve	Stabilize and filter air source pressure
Limit switch	Remote feedback switch signal
Manual device	Manual device can open and close valve manually
Positioner	Input analog signal (4-20mA or 0-10V), Adjust valve travel
Remark	The above accessories are not standard accessories, if you need them, please indicate when ordering, solenoid valve and limit switch are divided into explosion-proof type and non-explosion-proof type, if you need explosion-proof type, please indicate the explosion-proof grade.

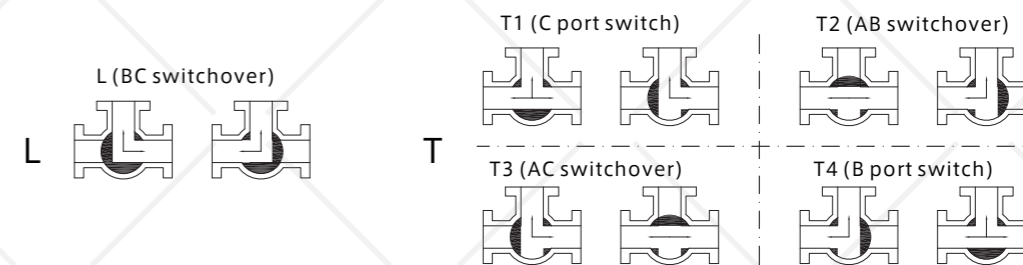
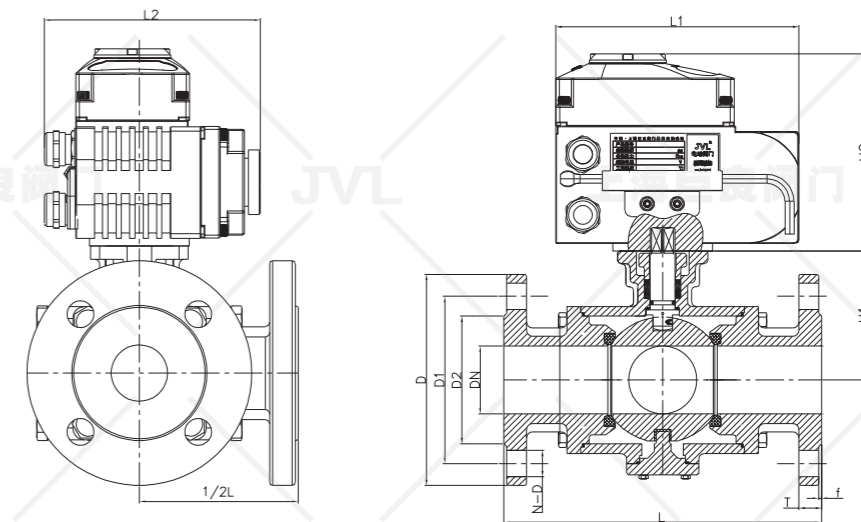

▼ ELECTRIC OVERALL DIMENSIONS CHART-PN16(16bar)

DN	Overall Dimension					Connection Dimension						Actuator Model
	L	L1	L2	H1	H2	D	D1	D2	T	f	N-D	
15	155	165/320	150/220	65	135/270	95	65	45	16	2	4-14	JLA05/JLB10
20	165	165/320	150/220	65	135/270	105	75	58	18	2	4-14	JLA05/JLB10
25	181	165/320	150/220	68	135/270	115	85	68	18	2	4-14	JLA05/JLB10
32	190	165/320	150/220	79	135/270	140	100	78	18	2	4-18	JLA05/JLB10
40	212	190/320	170/220	85	140/270	150	110	88	18	2	4-18	JLA10/JLB15
50	232	270/355	220/250	93	170/275	165	125	102	18	2	4-18	JLA20/JLB20
65	290	270/355	220/250	121	170/275	185	145	122	18	2	8-18	JLA20/JLB20
80	310	270/375	220/290	153	170/315	200	160	138	20	2	8-18	JLA20/JLB30
100	350	270/375	220/290	171	170/315	220	180	158	20	2	8-18	JLA60/JLB40

●Note: According to different valve torque, different voltage and different actual working conditions, select the matched actuator, and its relevant dimensions change accordingly.

▼ Control mode selection

Standard switch type	Active switching quantity control, passive switching quantity feedback
Integral switch type	Passive switching quantity control, passive switching quantity feedback
Integral regulating type	Analog quantity control(4-20mA), Analog quantity feedback(4-20mA)
RS485 Field bus type	Support RS485 communication
Remark	Other type of control signal and feedback signal can be customized according to customers' requirements