

GATE VALVE

JVL

JVL



Model: JL900-Z1/C4/H/16/C/100/D1/W4/B8

Design Feature

- Bidirectional flow, smooth channel, effortless opening and closing, small flow resistance.
- High temperature resistance, high pressure resistance, corrosion resistance, wear resistance, widely used.
- With buffer mechanism, manual switching mechanism, waterproof hammer, flexible & reliable.
- Elastic wedge gate, automatic compensation function, good sealing performance, long service life.

Model Naming Method

JL	-900	-Z1	-C4	-H	-16	-C	-100	-D1	-	-W4	-	-
Juliang brand	Electric	Gate valve	Flange	Metal hard sealing	PN	WCB	DN	Double acting	Anti explosion class	-29°-425°C	Attachment selection	Attachment selection

Technical Parameter

DN	DN50~800mm (Please indicate if need other DN when ordering)
Nominal pressure	1.6~6.4Mpa(Please indicate if need other pressure when ordering)
Body material	WCB(C), SS304(P), SS316(R)
Sealing material	Metal hard seal (H), Hard alloy (Y)
Medium temp.	W3:-20~250°C W4:-29~425°C
Connection mode	Flange, Butt welding
Pneumatic actuator	JLAT series, JLAW series, Imported actuator series
Action mode	Double acting, Single acting normally closed, Single acting normally open
Electric actuator	JLA series, JLB series, Imported actuator series
Control mode	Standard switch type, Integral regulating type, Integral switch type, Field bus type

• Notes: Other special sealing materials and special temperature can be selected according to customers' requirements.

Main component table

No.	Part Name	No.	Part Name
1	Valve body	11	Bolt
2	Nut	12	Packing
3	Bolt	13	Packing sleeve
4	Gate plate	14	Packing plate
5	Stem	15	Nut
6	Washer	16	Pneumatic actuator
7	Bonnet	17	Air source outlet
8	Nut	18	Valve position marking rod
9	Eye bolt	19	Electric actuator
10	Nut		

• Note: The materials of main parts and sealing ring can be designed and selected according to the actual working conditions or customers' requirements.

Technical specification

Design consideration	GB
Design standard	GB/T 12232
Structure length	GB/T 12221
Flange connection	JB/T 79
Test & Inspection standard	JB/T 9092

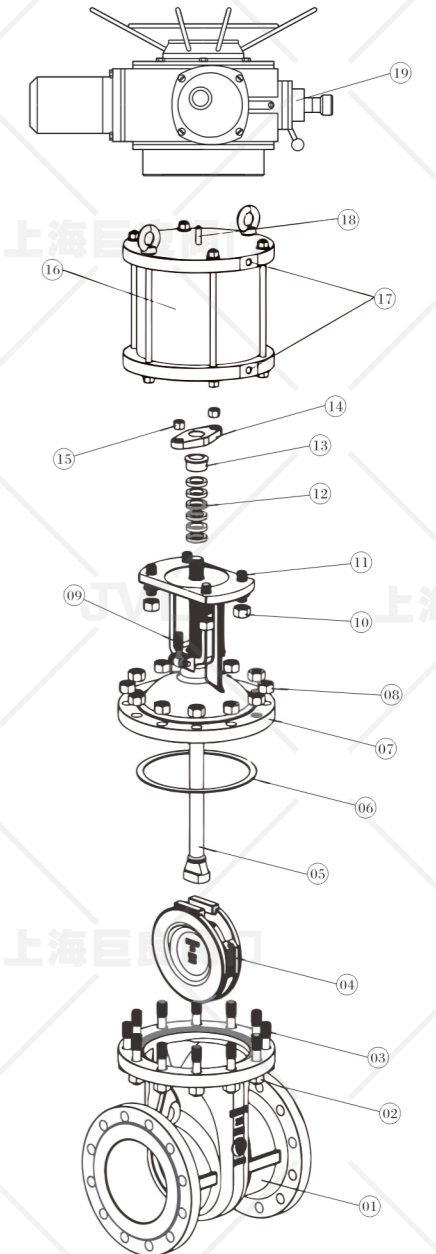

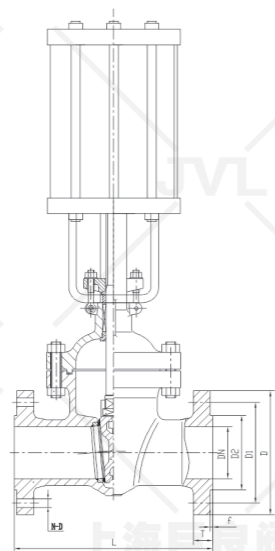

▼ PNEUMATIC OVERALL DIMENSIONS CHART-PN16(16bar)

DN	Overall Dimension		Connection Dimension				
	L	D	D1	D2	T	f	N-D
50	250	165	125	99	20	3	4-18
80	280	200	160	132	20	3	8-18
100	300	220	180	156	22	3	8-18
150	350	285	240	211	24	3	8-22
200	400	340	295	266	24	3	12-22
250	450	405	355	319	26	3	12-26
300	500	460	410	370	28	4	12-26
350	550	520	470	429	30	4	16-26
400	600	580	525	480	32	4	16-30
450	650	640	585	548	34	4	20-30
500	700	715	650	609	36	4	20-33
600	800	840	770	720	38	5	20-36
700	900	910	840	794	40	5	24-36
800	1000	1025	950	901	42	5	24-39

●Note: According to different valve torque, different air supply pressure and different actual working conditions, select the matched actuator, and its relevant dimensions change accordingly.

▼ Attachment selection

Solenoid valve	3/2, 5/2, single electric control and double electric control, please indicate when ordering
Filter pressure reducing valve	Stabilize and filter air source pressure
Limit switch	Remote feedback switch signal
Manual device	Open and close valve manually
Positioner	Input analog signal (4-20mA or 0-10V),adjust valve travel
Remark	The above accessories are not standard accessories, if you need them, please indicate when ordering, solenoid valve and limit switch are divided into explosion-proof type and non-explosion-proof type, please indicate the explosion-proof grade if you need.

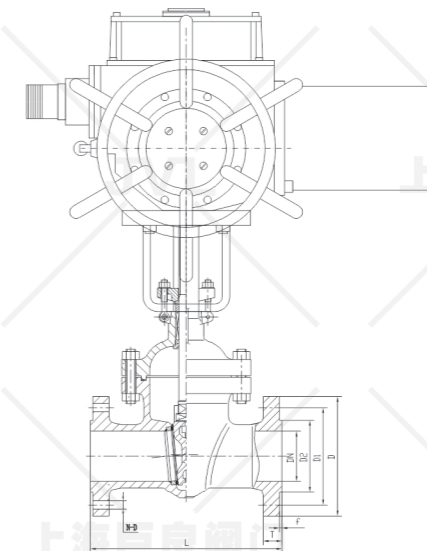

▼ ELECTRIC OVERALL DIMENSIONS CHART-PN16(16bar)

DN	Overall Dimension		Connection Dimension				
	L	D	D1	D2	T	f	N-D
50	250	165	125	99	20	3	4-18
80	280	200	160	132	20	3	8-18
100	300	220	180	156	22	3	8-18
150	350	285	240	211	24	3	8-22
200	400	340	295	266	24	3	12-22
250	450	405	355	319	26	3	12-26
300	500	460	410	370	28	4	12-26
350	550	520	470	429	30	4	16-26
400	600	580	525	480	32	4	16-30
450	650	640	585	548	34	4	20-30
500	700	715	650	609	36	4	20-33
600	800	840	770	720	38	5	20-36
700	900	910	840	794	40	5	24-36
800	1000	1025	950	901	42	5	24-39

●Note: According to different valve torque, different voltage and different actual working conditions, select the matched actuator, and its relevant dimensions change accordingly.

▼ Control mode selection

Standard switch type	Active switching quantity control, passive switching quantity feedback
Integral switch type	Passive switching quantity control, passive switching quantity feedback
Integral regulating type	Analog quantity control(4-20mA), Analog quantity feedback(4-20mA)
RS485 Field bus type	Support RS485 communication
Remark	Other type of control signal and feedback signal can be customized according to customers' requirements