



ZCF HIGH-END FLANGED PISTON SOLENOID VALVE

GERMAN HARDCOVER/REPLACING IMPORTED GOODS/SIMPLE STRUCTURE/SUPER LONG LIFE

Valve selection

- The direction of arrow on the valve body must be consistent with the flow of the medium, if there is bi-directional flow, may select electric valve or pneumatic valve.
- If contain impurity particles in the fluid, the strainer should be installed in front of the valve according to the particle size (the mesh number ≥ 80).
- The length of DC power cord should not be too long to avoid coil power loss and normal operation.
- Please give preference to the normally closed type in the design control plan.
- If you need explosion-proof solenoid valve, long duration power on and special voltage requirements, please consult before selecting the model.

Model Naming Method

JLB	ZCF	-1	-K	-RL	DN15	HG/T
Special code	Model	Medium temp.	Function mode	Body material	Nominal diameter	Flange executive standard
B→BT4 Anti-explosion BZ→CT5 Anti-explosion No special, blank		1:-20°C~80°C 2:-20°C~150°C 3:100°C~200°C 4:120°C~250°C	Blank→Normally closed K→Normally open S→Manual device X→Signal device	Blank→CF8 or 304 RL→CF3M or 316L C→WCB Cast steel	DN15→15mm DN20→20mm	Blank→Chemical Engineering Department Flange→HG/T Flange→SH/T
						Other important parameters

Technical parameter

DN	DN20~100mm
Connection mode	Flange (Executive standard: GB/T 9113-2010, chemical, petrol, American standard can be customized)
Principle	Pilot operated type
Valve body material	Cast steel, SS304, SS316R and SS316L(RL) can be customized
Sealing material	NBR, FKM, PTFE, others please consult
Suitable medium	Liquid, Gas, Vapor, Oil etc.
Medium temperature	1.-20°C~80°C 2.-20°C~150°C 3.100°C~200°C 4.120°C~250°C others please consult
Ambient temperature	Standard type: -20°C~60°C
Installation mode	Horizontal installation, coil vertical upward (others please consult)
Protection level	Iron housing type: IP54 Plastic sealing type: IP65 Explosion-proof type: BT4: IP54 CT5: IP65

• Notes: Special conditions can be designed and manufactured according to the customer's actual conditions.

Power parameter

Supply Voltage	AC:220V DC:24V other voltages can be customized
Rated power	J5 AC20VA DC19W
	J7 AC22VA DC25W
	J8 AC40VA DC37W
Voltage deviation	±10%
Electrical connection	Standard type: DIN43650A, Standard junction box(M18x1.5) Anti-explosion type: Standard G1/2" inner thread Power cord of IP54 can be replaced, but IP65 can't

Product function selection

Symbol	Function mode	Content
Blank	Normally closed	Energized valve on, deenergized valve off
K	Normally open	Energized valve off, deenergized valve on
X	Signal feedback	Passive contact signal feedback, reflect on-off state of valve.
S	Hand device	Manual on-off valve
Notes	Anti-explosion level: Ex dbII BT4 Gb, Ex dbII CT5 Gb Special device related qualification please ask for from our sales	

ZCF**HIGH-END FLANGED PISTON SOLENOID VALVE****JVL®**

Applications: medical equipment, food machinery, agricultural machinery, analytical instruments, humidifier, sulfur meter, water dispenser, mold temperature machine, bottle blowing machine, filling equipment, brewing equipment, generator set, environmental water treatment, industrial kiln, boiler burner, welding cutting and matching with welding and cutting products and automation control system of related industries.

GERMAN HARDCOVER/REPLACING IMPORTED GOODS/SIMPLE STRUCTURE/SUPER LONG LIFE

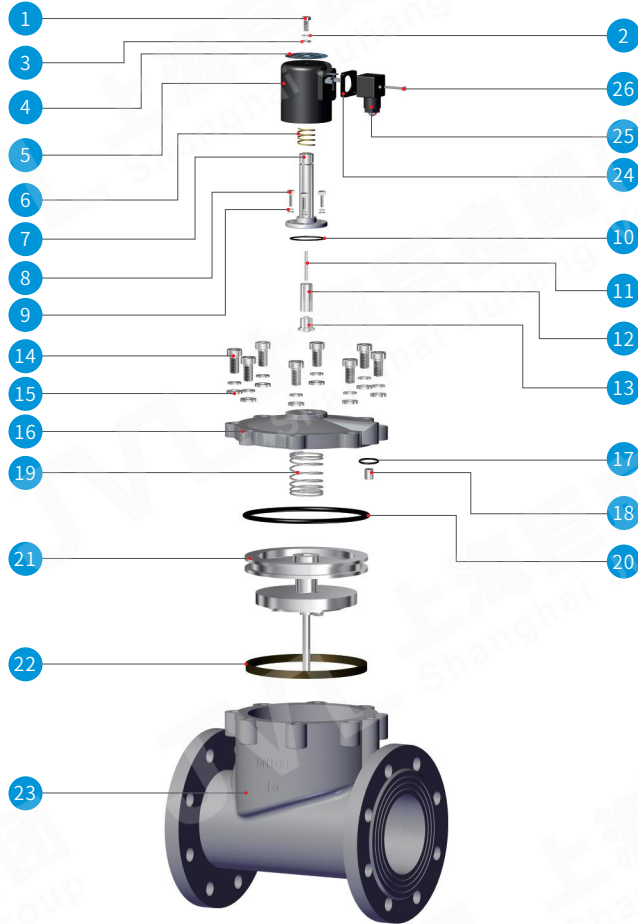
**Part component description**

NO.	Name	NO.	Name
1	M6 outer hex nut	14	Main bonnet fastening bolt
2	D6 spring washer	15	Spring washer
3	D6 flat washer	16	Main bonnet
4	Name plate	17	Pilot hole seal
5	Electromagnetic coil	18	Pilot throttling pipe
6	Anti-shock spring	19	Reset spring of main valve
7	Pilot bonnet component	20	Main bonnet seal
8	Pilot bonnet fastening bolt	21	Main valve core component
9	Spring washer& flat washer	22	Elastic seal ring of main valve core
10	Pilot bonnet seal	23	Valve body
11	Reset spring	24	Protective pad for junction box
12	Moving iron core component	25	Junction box
13	Small valve core component	26	M3 bolt

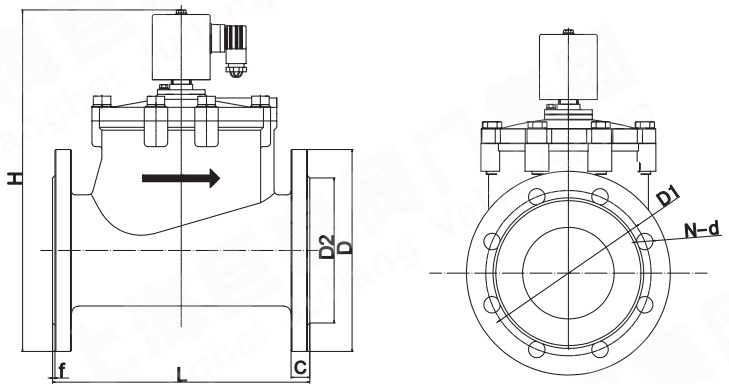
**Normally closed standard product specifications & dimensions**

Flange executive standard:GB/T 9113-2010

Type	Nominal diameter DN[mm]	Differential pressure range[bar]			Outer shape dimension						
		AC	DC	L	H	D	D1	D2	N-d	f	c
ZCF20	20	0.5~25	0.5~25	130	157	105	75	58	4-φ14	2	18
ZCF25	25	0.5~25	0.5~25	140	164	115	85	68	4-φ14	2	18
ZCF32	32	0.5~25	0.5~25	165	188	140	100	78	4-φ18	2	18
ZCF40	40	0.5~25	0.5~25	165	195	150	110	88	4-φ18	3	18
ZCF50	50	0.5~25	0.5~25	180	246	165	125	102	4-φ18	3	20
ZCF65	65	0.5~25	0.5~25	220	302	185	145	122	8-φ18	3	22
ZCF80	80	1~16	1~16	240	343	200	160	138	8-φ18	3	20
ZCF100	100	1~16	1~16	280	373	220	180	158	8-φ18	3	22

Notes: 1. The above technical data and installation dimensions are standard designs. If added functional options or pipeline design is strict, you can ask "Overall drawing" from our company. Other pressure grade or special technical requirements shall be subject to the appointment of contract and physical products.
2. If the solenoid valve is used in explosion-proof conditions, please ask explosion-proof solenoid valve's "Overall drawing" from our company.