



ZCZP CHASE DRIVE PILOT PISTON SOLENOID VALVE

JVL THE CHOICEST GOODS/TESTED FOR A LONG TIME/PISTON STRUCTURE/RELIABLE PERFORMANCE

Valve selection

- The direction of arrow on the valve body must be consistent with the flow of the medium, if there is bi-directional flow, may select electric valve or pneumatic valve.
- If contain impurity particles in the fluid, the filter screen should be installed in front of the valve according to the particle size (the filter net ≥ 80 mesh).
- DC power cord length should not be too long to avoid coil power loss and normal operation.
- Please give preference to the normally closed type in the design control plan.
- If need explosion-proof solenoid valve, long duration power on and special voltage requirements, please consult before selecting the model.

Model naming method

JLB	ZCZP	-1	-K	-RL	DN20	HG/T
Special code	Model No.	Medium temp select	Function select	Body material select	DN Select	Flange executive standard
B→BT4Anti-explosion BZ→CT5Anti-explosion No special,omitted		1:-20°C~80°C 2:-20°C~150°C 3:100°C~200°C 4:120°C~250°C	Omitted→normally close K→Normally open S→Manual device X→Signal device	Omitted→CF8 or 304 RL→CF3M or 316L C→WCB or Cast steel	DN20→20mm DN25→25mm	Flange→HG/T Flange→JB/T Flange→SH/T

Other important parameters

Technical parameter

DN	DN20~300mm
Connection mode	Flange (Executive standard: HG/T20592-2009, JB/T Flange, SH/T Flange, and American standard etc. can be customized)
Principle	Distributed pilot mode
Valve body material	Cast steel, SS304, SS316(-R) and SS316L(-RL) can be customized
Sealing material	NBR,FKM. PTFE. other material please consult
Suitable medium	Vapor,Liquid, Gas, Oil etc
Medium temperature	1.-20°C~80°C 2.-20°C~150°C 3.100°C~200°C 4.120°C~250°C others please consult
Ambient temperature	Standard Mode: -20°C~60°C
Installation mode	Horizontal installation coil vertical upward (others please consult)
Protection level	Iron Housing type:IP54 Flame proof:BT4:IP54 CT5:IP65

•Notes: Special conditions can be designed and manufactured according to the customer's actual conditions.

Power parameter

Supply Voltage	AC:220V DC:24V other electrical be customized
Rated power	J8 AC40VA DC37W J10 AC45VA DC48W
Voltage deviation	±10%
Electrical connection	Standard type:DIN43650A Standard junction box(M18x1.5) Anti-explosion:Standard G1/2" inner thread IP54 can replace power cord, IP65 non replace

Product function selection

Symbol	Function name	Content
Omitted	Normally close	Energized valve on, deenergized valve off
K	Normally open	Energized valve off, deenergized valve on
X	Signal feedback	Passive contact signal feedback, reflect on-off state of valve.
S	Hand device	Manual on-off valve
D	With timer	Set time switch interval
Notes	Anti-explosion level: Ex dbII BT4 Gb, Ex dbII CT5 Gb special device related qualification please ask for from our sales	

Products applied scope: aerospace and aviation, national defense military industry, petrochemical industry, HVAC, iron and steel metallurgy, electric equipment, medical equipment, food machinery, agricultural machinery, analytical instruments, humidifier, generator set, environmental water treatment, industrial kiln, boiler burner, filling Equipment, brewing equipment, drying equipment, vacuum equipment and other products and related industry automation control system.

MILITARY ACCESSORIES/WIDELY USED/COMPLETE FUNCTIONS/SUPER LONG LIFETIME

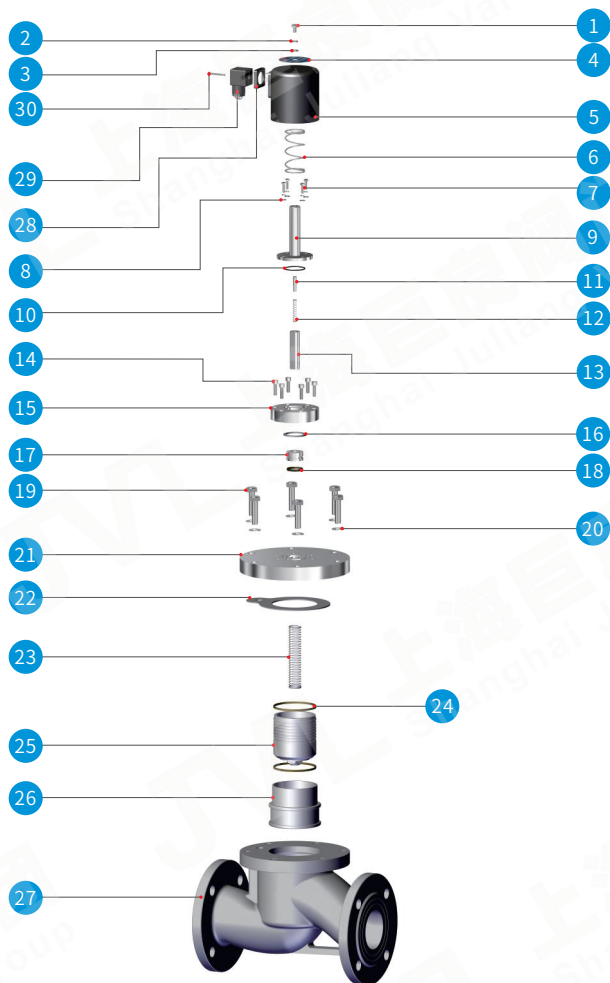

Part component description

NO.	Name	NO.	Name
1	M6 outer hex nut	16	Piston ring of small valve core
2	D6 Spring washer	17	Small valve core
3	D6 Flat washer	18	Elastic seal ring of small valve core
4	Name plate	19	Main bonnet fastening bolts
5	Electromagnetic coil	20	Spring washers
6	Anti-shock spring	21	The main valve cover
7	Pilot bonnet tightening bolts	22	Main bonnet seal
8	Spring washer	23	Reset spring of main valve
9	Pilot bonnet component	24	Elastic seal ring of main valve core
10	Pilot bonnet seal	25	Main valve core
11	Reset to prod	26	Main valve core bushing
12	Reset spring	27	valve body
13	Moving core component	28	Protective pad for junction box
14	Middle cover fastening bolt	29	Junction box
15	Middle cover plate	30	M3 bolt

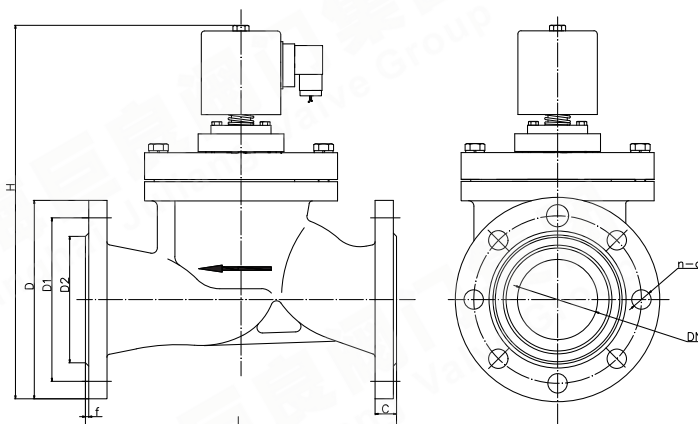

Normally closed standard product specifications & dimensions

Flange executive standard:HG/T 20592-2009

Type	Nominal diameter DN[mm]	Differential pressure range[bar]		Flange Size							
		AC	DC	L	H	D	D1	D2	n-d	f	C
ZCZP20	20	0.5~16	0.5~16	150	232	φ105	φ75	φ56	4-φ14	2	16
ZCZP25	25	0.5~16	0.5~16	160	253	φ115	φ85	φ65	4-φ14	3	16
ZCZP32	32	0.5~16	0.5~16	180	275	φ140	φ100	φ76	4-φ18	3	18
ZCZP40	40	0.5~16	0.5~16	200	297	φ150	φ110	φ84	4-φ18	3	18
ZCZP50	50	0.5~16	0.5~16	230	318	φ165	φ125	φ99	4-φ18	3	20
ZCZP65	65	1~16	1~16	290	342	φ185	φ145	φ118	4-φ18	3	20
ZCZP80	80	1~16	1~16	310	360	φ200	φ160	φ132	8-φ18	3	20
ZCZP100	100	1~16	1~16	350	400	φ220	φ180	φ156	8-φ18	3	22
ZCZP125	125	1~16	1~16	400	490	φ250	φ210	φ184	8-φ18	3	22
ZCZP150	150	1.5~16	1.5~16	480	542	φ285	φ240	φ211	8-φ22	3	24
ZCZP200	200	1.5~16	1.5~16	600	586	φ340	φ295	φ266	12-φ22	3	24
ZCZP250	250	1.5~16	1.5~16	650	636	φ405	φ355	φ319	12-φ26	3	26
ZCZP300	300	1.5~16	1.5~16	750	720	φ460	φ410	φ370	12-φ26	3	28

- Notes: 1. The above of technical data & mount size is standard design, if attach function option or pipe fit design strict, please ask us for "Outer size figure". Other grade pressure or specific requirement be subject to confirmed appointment or actual product.
- 2. When using anti-explosion situation, should asked us for anti-explosion "Outer size drawing"