



# ZCY/B HIGH-END HIGH PRESSURE BRASS SOLENOID VALVE

GERMAN HARDCOVER/ REPLACING IMPORTED GOODS/SKILLED TECHNOLOGY

## Valve selection

- The direction of arrow on the valve body must be consistent with the flow of the medium, if there is bi-directional flow, may select electric valve or pneumatic valve.
- If contain impurity particles in the fluid, the strainer should be installed in front of the valve according to the particle size (the mesh number≥80).
- The length of DC power cord should not be too long to avoid coil power loss and normal operation.
- Please give preference to the normally closed type in the design control plan.
- If you need explosion-proof solenoid valve, long duration power on and special voltage requirements, please consult before selecting the model.

## Model Naming Method

JLB

Special code

BM→CT4 Anti-explosion type  
No special, blank

.....

ZCY

Model

ZCY→Diaphragm type  
ZCB→Piston type

-1

Medium temp.  
1: -20°C~80°C  
2: -20°C~150°C

-K

Function mode

Blank→Normally closed  
K→Normally open

.....

DN15

Nominal diameter  
DN15→15mm  
DN25→25mm

G1/4

Connection mode  
G1/4~G1  
.....

Other important parameters

## Technical parameter

DN	DN15~25mm
Connection mode	English system G internal thread(NPT thread can be customized)
Principle	Pilot diaphragm、Pilot piston mode
Valve body material	Brass
Sealing material	NBR、FKM、others please consult
Suitable medium	Gas, Liquid, Oil etc.
Medium temperature	1. -20°C~80°C 2. -20°C~150°C others please consult
Ambient temperature	Standard type: -20°C~60°C
Installation mode	Horizontal installation, coil vertical upward (others please consult)
Protection level	Plastic sealing type: IP65 Encapsulation type: IP65

• Notes: Special conditions can be designed and manufactured according to the customer's actual conditions.

## Power parameter

Supply Voltage	AC:220V DC:24V other voltages can be customized
Rated power	J3 AC22VA DC18W
Voltage deviation	±10%
Anti-explosion type:	Standard type: DIN43650A/B, Standard junction box(M18x1.5) Power cord of IP54 can be replaced, but IP65 can't

## Product function selection

Symbol	Function mode	Content
Blank	Normally closed	Energized valve on, deenergized valve off
K	Normally open	Energized valve off, deenergized valve on
M	Energy-saving	Energy saving and reducing temperature rise.
Notes	Anti-explosion level: Ex dbII BT4 Gb, Ex dbII CT5 Gb special device related qualification please ask for from our sales	

# ZCY/B HIGH-END HIGH PRESSURE BRASS SOLENOID VALVE

Applications: petrochemical, HVAC, medical equipment, food machinery, agricultural machinery, analytical instruments, stage equipment, rubber and plastic machinery, air compressor, bottle blowing machine, filling equipment, brewing equipment, generator set, environmental water treatment, industrial kiln, boiler combustion Burners, matching with welding and cutting products and automation control system of related industries.

SUPER LONG LIFETIME /GOOD QUALITY/ECONOMICAL AND APPLICABLE

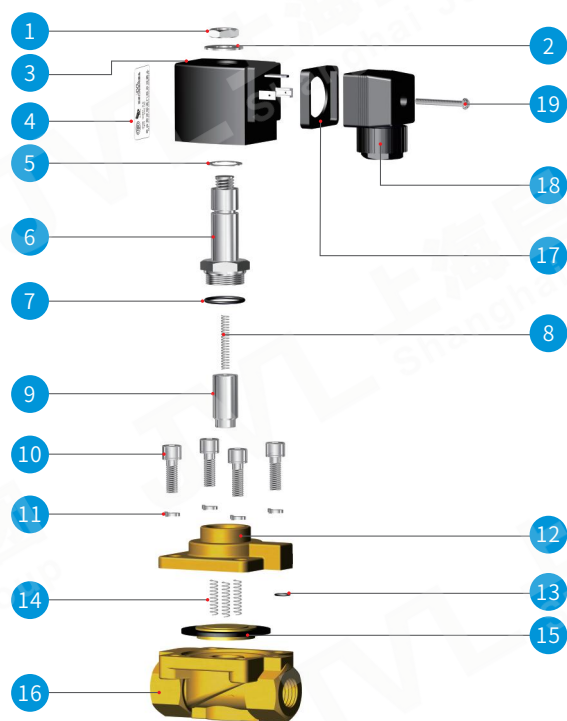

ZCY(Figure 1)

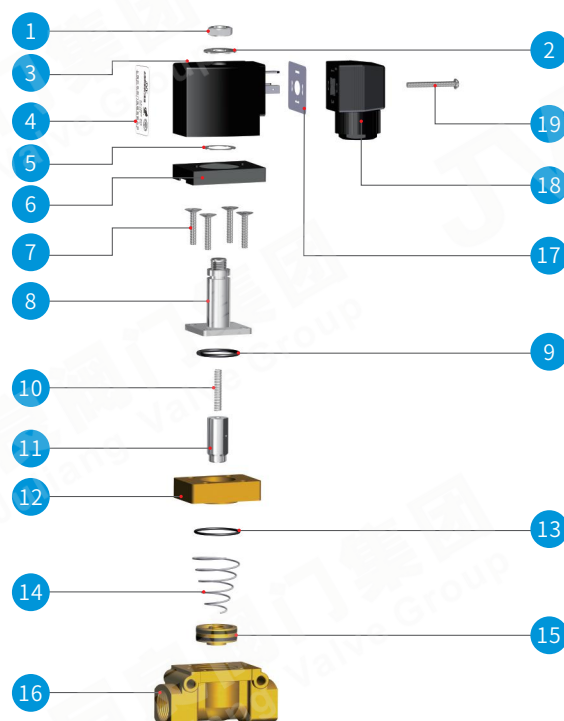

ZCB(Figure 2)

### ZCY Part component description(Figure 1)

NO.	Name	NO.	Name
1	M10 outer hex nut	11	Spring washer
2	Flat washer	12	Main bonnet
3	Electromagnetic coil	13	Pilot hole seal
4	Name plate	14	Reset spring of main valve
5	Anti-shock spring washers	15	Main valve diaphragm
6	Pilot cover component	16	valve body
7	Pilot bonnet seal	17	Protective pad for junction box
8	Reset spring	18	Junction box
9	Moving iron core component	19	M3 bolt
10	Main bonnet fastening bolts		

### ZCB Part component description(Figure 2)

NO.	Name	NO.	Name
1	M10 outer hex nut	11	Moving iron core component
2	Flat washer	12	Mainbonnet
3	Electromagnetic coil	13	Main bonnet seal
4	Name plate	14	Reset spring of main valve
5	Anti-shock spring washer	15	Main valve core component
6	Bonnet housing	16	valve body
7	Bonnet fastening bolts	17	Protective pad for junction box
8	Pilot bonnet component	18	Junction box
9	Pilot bonnet seal unit	19	M3 bolt
10	Reset spring		

# ZCY/B HIGH-END HIGH PRESSURE BRASS SOLENOID VALVE

Applications: petrochemical, HVAC, medical equipment, food machinery, agricultural machinery, analytical instruments, stage equipment, rubber and plastic machinery, air compressor, bottle blowing machine, filling equipment, brewing equipment, generator set, environmental water treatment, industrial kiln, boiler combustion Burners, matching with welding and cutting products and automation control system of related industries.

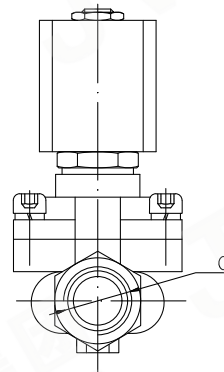
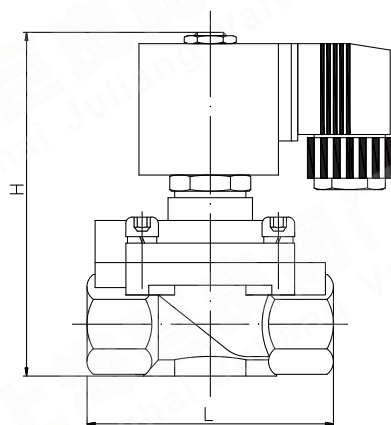

ZCY( Figure 1)

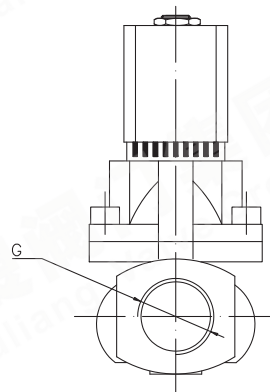
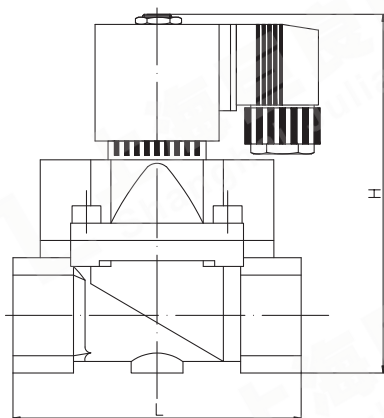

ZCB( Figure 2)

## ZCY Normally closed standard product specifications & dimensions( Figure 1)

Type	Nominal diameter DN[mm]	Pipe thread [G]	Differential pressure range[bar]		L	H
			AC	DC		
ZCY15	15	G1/4"	1~35	1~35	75	102
ZCY15	15	G1/4"	1~35	1~35	75	102
ZCY15	15	G3/8"	1~35	1~35	75	102
ZCY15	15	G1/2"	1~35	1~35	75	102
ZCY15	15	G3/4"	1~35	1~35	75	102

## ZCB Normally closed standard product specifications & dimensions( Figure 1)

Type	Nominal diameter DN[mm]	Pipe thread [G]	Differential pressure range[bar]		L	H
			AC	DC		
ZCB15	13	G1/4"	1~50	1~50	72	98
		G1/4"	1~50	1~50	72	98
		G3/8"	1~50	1~50	72	98
		G1/2"	1~50	1~50	72	98
ZCB20	25	G3/4"	1~50	1~50	100	125
ZCB25	25	G1"	1~50	1~50	100	125

Notes: 1.The above technical data and installation dimensions are standard designs. If added functional options or pipeline design is strict, you can ask "Overall drawing" from our company. Other pressure grade or special technical requirements shall be subject to the appointment of contract and physical products.  
2.If the solenoid valve is used in explosion-proof conditions, please ask explosion-proof solenoid valve's "Overall drawing" from our company.