



Z3CD

EXPORT SERIES 3/2 BRASS SOLENOID VALVE

Z3BS

EXPORT SERIES 3/2 STAINLESS STEEL SOLENOID VALVE

Valve selection

- The direction of arrow on the valve body must be consistent with the flow of the medium, if there is bi-directional flow, may select electric valve or pneumatic valve.
- If contain impurity particles in the fluid, the strainer should be installed in front of the valve according to the particle size (the mesh number≥80).
- The length of DC power cord should not be too long to avoid coil power loss and normal operation.
- Please give preference to the normally closed type in the design control plan.
- If you need explosion-proof solenoid valve, long duration power on and special voltage requirements, please consult before selecting the model.

Model Naming Method

JLB

Special code
BZ→CT5 Anti-explosion
BM→CT4 Anti-explosion
No special, blank
.....

Z3CD

Model
Z3CD→Brass
Z3BS→Stainless steel

-1

Medium temp.
1:-20°C~80°C
2:-20°C~150°C
3:100°C~200°C

-M

Function mode
Blank→Normally closed
M→Energy-saving device
.....

-RL

Body material
Blank→SS304
Blank→Brass
RL→SS316L
.....

DN1

Nominal diameter
DN1→1mm
DN2→2mm
.....

G1/2

Connection mode
G1/8~G1/2
NPT1/8~NPT1/2
.....

Other important parameters

Technical parameter

DN	DN1~10mm
Connection mode	English G Internal thread, NPT internal thread (other can be customized)
Principle	Direct acting piston mode
Valve body material	Brass, SS304, and SS316L(-RL) can be customized
Sealing material	NBR, FKM, PTFE, others please consult
Suitable medium	Liquid, Gas, Oil etc.
Medium temperature	1.-20°C~80°C 2.-20°C~150°C 3.100°C~200°C (others please consult)
Ambient temperature	Standard type: -20°C~60°C
Installation mode	Horizontal installation, coil vertical upward (others please consult)
Protection level	Iron housing type: IP54 Plastic sealing type: IP65 Encapsulation type: IP65 CT5: IP65

- Notes: Special conditions can be designed and manufactured according to the customer's actual conditions

Power parameter

Supply Voltage	AC:220V DC:24V other voltages can be customized
Rated power	J3 AC18VA DC19W
	J5 AC20VA DC19W
	J8 AC40VA DC37W
Voltage deviation	±10%
Electrical connection	Standard type: DIN3650A/B, Standard junction box(M18x1.5) Anti-explosion type: Standard M14x1.5 or G1/2 inner thread power cord can not be replaced, reserved length 1.5M

Product function selection

Symbol	Function mode	content
Blank	Normally closed	Energized valve on, deenergized valve off
M	Energy saving device	Energy saving and reducing temperature rise.
Notes	Anti-explosion level: Ex dbII CT5 Gb, Ex mb IIT4 Gb Special device related qualification please ask for from our sales	

Z3CD

EXPORT SERIES 3/2 BRASS SOLENOID VALVE

Z3BS

EXPORT SERIES 3/2 STAINLESS STEEL SOLENOID VALVE

Applications: medical equipment, food machinery, agricultural machinery, analytical instruments, water dispenser, bottle blowing machine, canning equipment, brewing equipment, generator set, environmental water treatment, textile machinery, pneumatic control, dry cleaning equipment, industrial kilns, boiler burners, welding and cutting products form a complete set of automation control system and related industry.

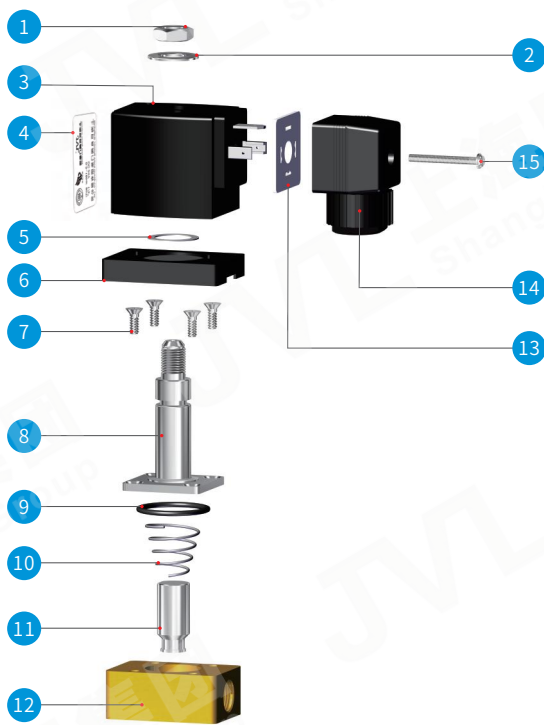

Z3CD (Figure 1)

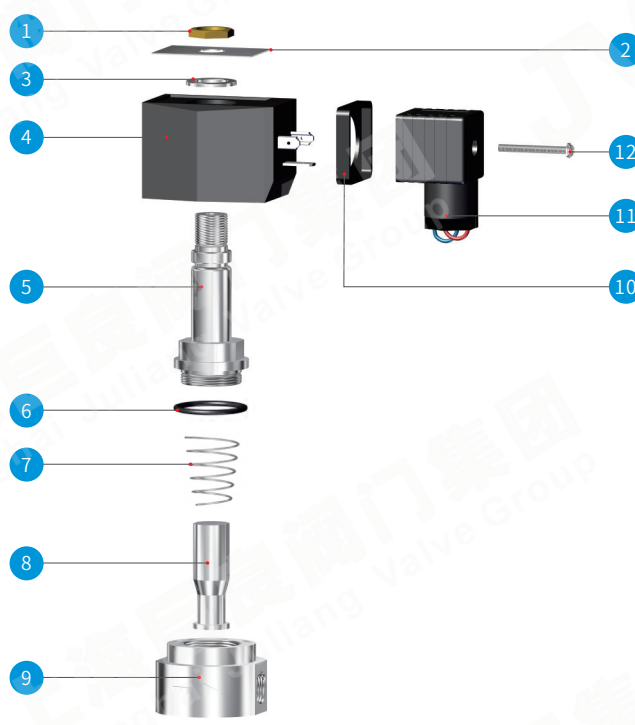

Z3BS (Figure 2)

Z3CD Part component description(Figure 1)

NO.	Name	NO.	Name
1	G 1/8 outer hex nut	9	Bonnet seal unit
2	Flat washer	10	Reset spring
3	Electromagnetic coil	11	Moving iron core component
4	Name plate	12	Valve body
5	Anti-shock spring washer	13	Protective pad for junction box
6	Bonnet housing	14	Junction box
7	Bonnet fastening bolts	15	M3 bolt
8	Bonnet component		

Z3BSPart component description(Figure 2)

NO.	Name	NO.	Name
1	G1/4 outer hex nut	9	Valve body
2	Name plate	10	Protective pad for junction box
3	Flat washer	11	Junction box
4	Electromagnetic coil	12	M3 bolt
5	Bonnet component		
6	Bonnet seal		
7	Reset spring		
8	Moving iron core component		

Z₃CD

EXPORT SERIES 3/2 BRASS SOLENOID VALVE

Z₃BS

EXPORT SERIES 3/2 STAINLESS STEEL SOLENOID VALVE

Applications: medical equipment, food machinery, agricultural machinery, analytical instruments, water dispenser, bottle blowing machine, canning equipment, brewing equipment, generator set, environmental water treatment, textile machinery, pneumatic control, dry cleaning equipment, industrial kilns, boiler burners, welding and cutting products form a complete set of automation control system and related industry.

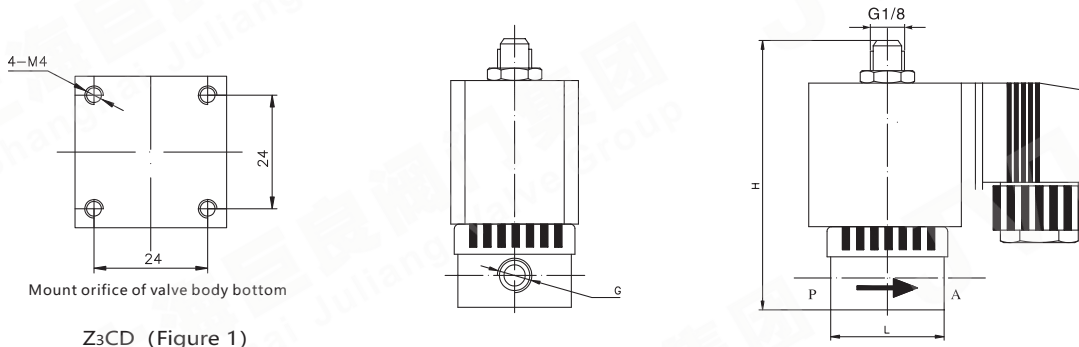

Z₃CD (Figure 1)

Z₃CD Normally closed standard product specifications & dimensions(Figure 1)

Model No. Specification	Nominal diameter DN[mm]	Pipe thread[G]		Differential pressure range[bar]			Overall dimensions	
		P/A	O	AC	DC	L	H	
Z ₃ CD1.5	1.5	G1/8"	G1/8"	0~10	0~10	32	76	
Z ₃ CD02	02	G1/4"	G1/8"	0~10	0~10	46	78	
Z ₃ CD03	03	G1/4"	G1/8"	0~8	0~8	46	78	

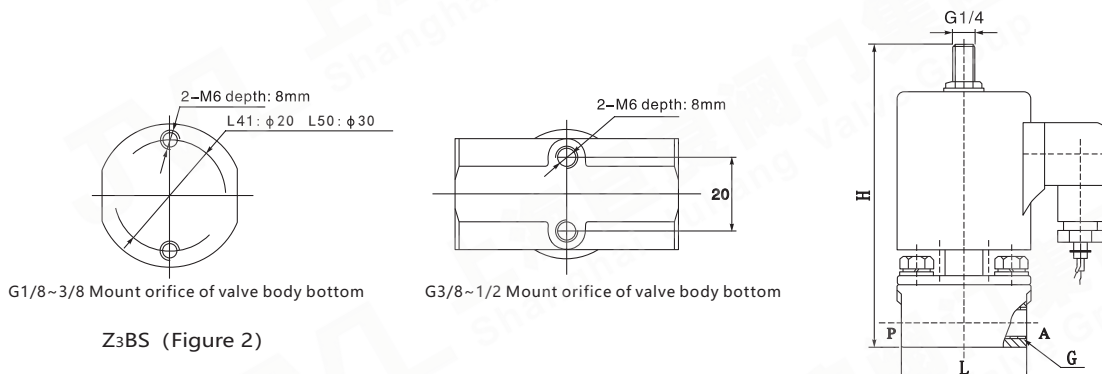

Z₃BS (Figure 2)

Z₃BS Normally closed standard product specifications & dimensions(Figure 2)

Model No. Specification	Nominal diameter DN[mm]	Pipe thread[G]		J5 Differential pressure range[bar]		J8 Differential pressure range[bar]		Overall dimensions	
		P/A	O	AC	DC	AC	DC	L	H
Z3BS01	1	G1/8"	G1/4"	0~12	0~12	-	-	41	88
Z3BS02	2	G1/8"	G1/4"	0~12	0~12	-	-	41	88
Z3BS03	3	G1/4"	G1/4"	0~12	0~12	-	-	41	88
Z3BS3.5	3.5	G1/4"	G1/4"	0~8	0~8	-	-	41	88
Z3BS05	5	G1/4"	G1/4"	0~4	0~4	-	-	41、50	88
Z3BS09	9	G1/4"、G3/8"	G1/4"	-	-	0~2	0~2	50、60	121
Z3BS10	10	G3/8"、G1/2"	G1/4"	-	-	0~1	0~1	60	130

• Notes : 1.The above technical data and installation dimensions are standard designs. If added functional options or pipeline design is strict, you can ask "Overall drawing" from our company. Other pressure grade or special technical requirements shall be subject to the appointment of contract and physical products.
2.If the solenoid valve is used in explosion-proof conditions, please ask explosion-proof solenoid valve's "Overall drawing" from our company.

Technical description (Figure 3)

1. Reversing: when the coil is energized, the static iron core attracts the moving iron core, and the gas or liquid is flowed during P and A. when coil power off,the moving core is closed the valve by acting of spring force ,the gas or liquid is flowed during A and O.
- 2.Shunt: when the coil is energized, the static core attracts the moving core, and the gas or liquid is flowed during A to P,when coil is power off,the moving core is closed by of spring force ,the gas or liquid is flowed during A and O.

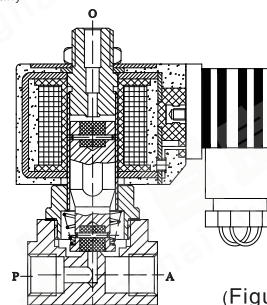

(Figure 3)