



HIGH-END ELECTROMAGNETIC GATE VALVE

U.S.-BASED HARDCOVER/REPLACING IMPORTS/SUPERB TECHNOLOGY/ULTRA-LONG LIFE

Valve selection

- The direction of arrow on the valve body must be consistent with the flow of the medium, if there is bi-directional flow, may select electric valve or pneumatic valve.
- If contain impurity particles in the fluid, the strainer should be installed in front of the valve according to the particle size (the mesh number ≥ 60).
- The length of DC power cord should not be too long to avoid coil power loss and normal operation.
- If you need explosion-proof solenoid valve, long duration power on and special voltage requirements, please consult before selecting the model.

Model naming Method

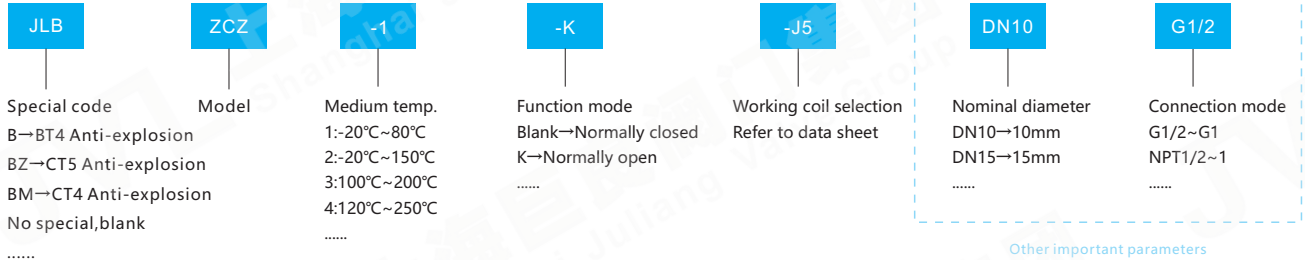

Technical parameter

DN	DN10~15m
Connection mode	English system G internal thread, American system NPT internal thread (other can be customized)
Principle	Direct acting gate mode
Valve body material	SS304
Sealing material	NBR, FKM, PTFE, others please consult
Suitable medium	Liquid, Gas, Vapour, and Oil with few particles etc.
Medium temperature	1.-20°C~80°C 2.-20°C~150°C 3.100°C~200°C 4.120°C~250°C others please consult
Ambient temperature	Standard type: -20°C~60°C
Installation mode	Horizontal installation, coil vertical upward (others please consult)
Protection level	Iron housing type: IP54 Plastic sealing type: IP65 Encapsulation type: IP65 Explosion-proof type: BT4:IP54 CT5:IP65

• Notes: Special conditions can be designed and manufactured according to the customer's actual conditions.

Power parameter

Supply Voltage	AC:220V DC:24V other voltages can be customized
Rated power	J5 AC20VA DC19W
	J7 AC22VA DC25W
	J8 AC40VA DC37W
	J10 AC50VA DC48W
Voltage deviation	±10%
Electrical connection	Standard type:DIN43650A/B, Standard junction box(M18x1.5) Anti-explosion type:Standard M14x1.5 or G1/2" inner thread Power cord of IP54 can be replaced, but IP65 can't



J5



J7



J8



J10



HIGH-END ELECTROMAGNETIC GATE VALVE

Application: medical equipment, food machinery, agricultural machinery, analytical instruments, humidifiers, sulfur analyzers, drinking fountains, bottle blowing machines, filling equipment, brewing equipment, generator sets, environmental protection water treatment, industrial kilns, Boiler burner, welding and cutting and other product supporting and related industries' automation control systems .

STRAIGHT-THROUGH STRUCTURE/EXCELLENT QUALITY/RECOMMENDED PRODUCTS

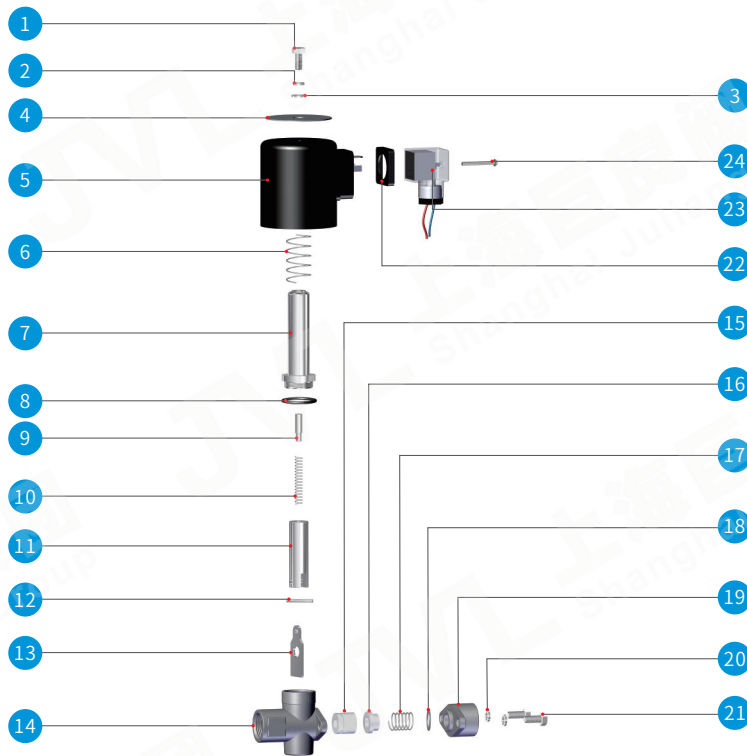

Part component description

NO.	Name
1	M6 outer hex nut
2	D6 spring washe
3	rD6 flat washer
4	Name plate
5	Electromagnetic coil
6	Anti-shock spring
7	Bonnet component
8	Bonnet seal
9	Reset top rod
10	Reset spring
11	Moving iron core component
12	Locating pin
13	Disc
14	Valve body
15	Cutting edge seal
16	Compression seal
17	Compression spring
18	Interface seal
19	Valve body interface
20	Spring washer
21	Fastening bolt of valve body
22	Protective pad for junction box
23	Junction box
24	M3 bolt

Product function selection

Symbol	Function mode	Content	Symbol	Function mode	Content
Omitted	Normally closed	Energized valve on, deenergized valve off			
K	Normally open	Energized valve off, deenergized valve on			
Notes	Anti-explosion level: Ex dbII BT4 Gb、 Ex dbII CT5 Gb、 Ex mb II T4 Gb special device related qualification please ask for from our sales				



HIGH-END ELECTROMAGNETIC GATE VALVE

Application: medical equipment, food machinery, agricultural machinery, analytical instruments, humidifiers, sulfur analyzers, drinking fountains, bottle blowing machines, filling equipment, brewing equipment, generator sets, environmental protection water treatment, industrial kilns, Boiler burner, welding and cutting and other product supporting and related industries' automation control systems .

ZERO PRESSURE OPENING AND CLOSING

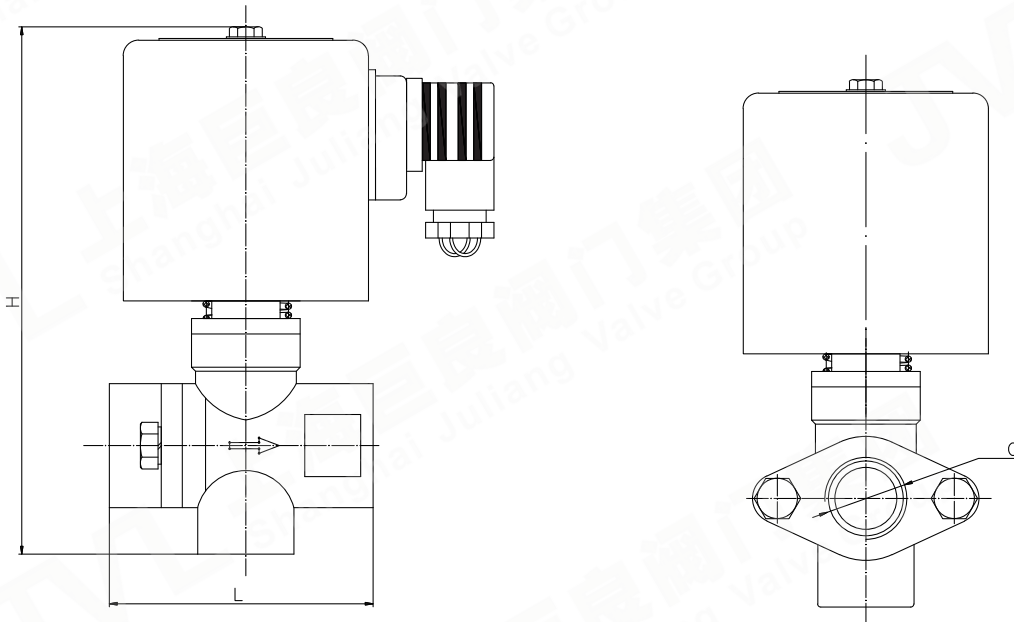

Normally closed standard product specifications

Type	Sealing material	Nominal diameter DN[mm]	Pipe thread [G]	J5 Differential pressure range[bar]		J7 Differential pressure range[bar]		J8 Differential pressure range[bar]		J9 Differential pressure range[bar]	
				AC	DC	AC	DC	AC	DC	AC	DC
ZCZ10	Teflon	10	G1/2"	0~3	0~1.5	0~4	0~2	0~7	0~5	-	-
ZCZ-10K				0~3	0~1.5	0~4	0~2	0~7	0~5	-	-
ZCZ10	Rubber	10	G1/2"	0~1	0~0.3	0~1.5	0~0.5	0~7	0~5	-	-
ZCZ-10K				0~1	0~0.3	0~1.5	0~0.5	0~7	0~5	-	-
ZCZ15	Teflon	15	G3/4"	-	-	-	-	-	-	0~7	0~2
ZCZ-15K			G1"	-	-	-	-	-	-	0~7	0~2

Note: the above technical parameters are provided in accordance with the standards. Other grades of pressure or special requirements are subject to the agreement and the actual goods.

Normally closed standard product dimensions

Type	Nominal diameter DN[mm]	Pipe thread [G]	Outer shape dimension							
			J5		J7		J8		J10	
			L	H	L	H	L	H	L	H
ZCZ10	10	G1/2"	73	106	73	106	73	138	-	-
ZCZ15	15	G3/4" ~ G1"	-	-	-	-	-	-	85	170

Notes: 1. Notes :1. The above technical data and installation dimensions are standard designs. If you need functional options or pipeline design is strict you can ask "Overall drawing" from our company. Other pressure grade or special technical requirements shall be subject to the appointment of contract and physical products.
2. If the solenoid valve is used in explosion-proof conditions, please ask explosion-proof solenoid valve's "Overall drawing" from our company.