



ZCK GAS EMERGENCY CUT-OFF SAFETY SOLENOID VALVE

(Manual open, energized valve off)

EXQUISITE TECHNIQUE/INSTANT POWER ON/QUICK CUT OFF/FLYING SAUCER PISTON

Valve selection

- The direction of arrow on the valve body must be consistent with the flow of the medium, if there is bi-directional flow, may select electric valve or pneumatic valve.
- If contain impurity particles in the fluid, the filter screen should be installed in front of the valve according to the particle size (the filter net ≥ 80 mesh).
- DC power cord length should not be too long to avoid coil power loss and normal operation.
- the valve only be energized instantly.
- If need explosion-proof solenoid valve, long duration power on and special voltage requirements, please consult before selecting the model.

Model naming method

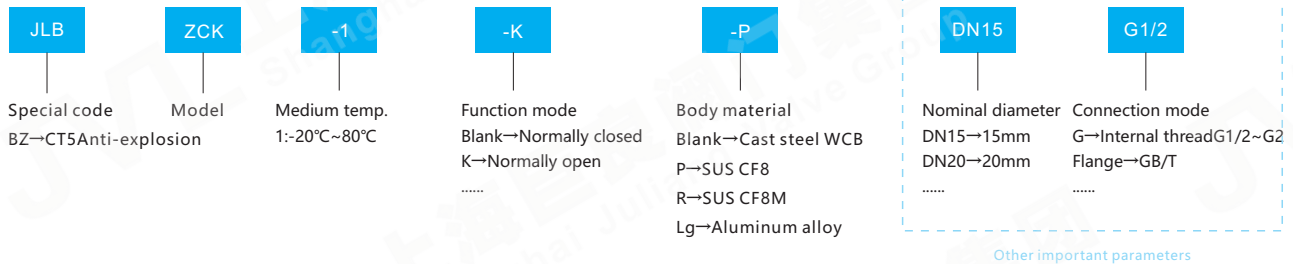

Technical parameter

DN	DN15~600mm
Connection mode	English system G internal thread, Flange GB/T9113.1-2000
Principle	Direct acting mode, Pilot mode
Valve body material	WCB, Aluminum alloy, SS304, Ss316
Seal material	NBR, FKM, others please consult
Suitable medium	Nature gas, coal gas, liquid petrol gas, methane flammable gas etc.
Medium temperature	1.-20°C~80°C
Ambient Medium temperature	Standard Mode: -20°C~60°C
Installation mode	Horizontal installation, coil vertical upward (others please consult)
Protection level	Anti-explosion: IP65

•Notes: Special conditions can be designed and manufactured according to the customer's actual conditions.

Power parameter

Instant supply voltage	AC:220V DC:24V other electrical be customized
Voltage deviation	$\pm 10\%$
Preparation for connection	1. Confirm whether the Control Power Supply voltage is consistent with the nominal power supply voltage of the solenoid valve. 2. Measure whether the fluctuation range of Control voltage value within the range -15%~+10% 3. Verify that the control output is pulse output (the duration energized time must be $< = 20S$)
Cut-off time	DN15~DN100 $\leq 1S$ DN125~DN600 $\leq 3S$
Electric connection	Anti-explosion type: standard G1/2 internal thread, junction box The power cord can't be replaced, and reserved length of power cord is 1 meter

Product function selection

Symbol	Function name	Content
Blank	Normally close	Manual open, deenergized valve off Control mode: manual open, instant power off, manual off
K	Normally open	Manual open, energized valve off Control mode: manual open, alarm signal close, manual closed, deenergized valve close (delay of 2-5 seconds after power supply system cut off, valve close automatically)
Notes		Anti-explosion level: Ex dbII CT5 Gb, special device related qualification please ask for from our sales

ZCK GAS EMERGENCY CUT-OFF SAFETY SOLENOID VALVE

(Manual open, energized valve off)

ACCIDENT SELF-LOCKING/MANUAL RESET/ENERGY-SAVING/SAFE AND RELIABLE

Application scope: gas emergency cut-off solenoid valve is a safety supporting device for gas pipeline engineering. It is widely used in combustible gas leakage monitoring instrument, central fire alarm system for high-rise buildings, gas supply pipe network system for cities or enterprises, thermal equipment, gas equipment, etc. Industrial kilns, boiler burners, thermal power plants, steel works and other pipe network safety system, to cut off flammable gas supply timely to prevent malignant events occurrence.

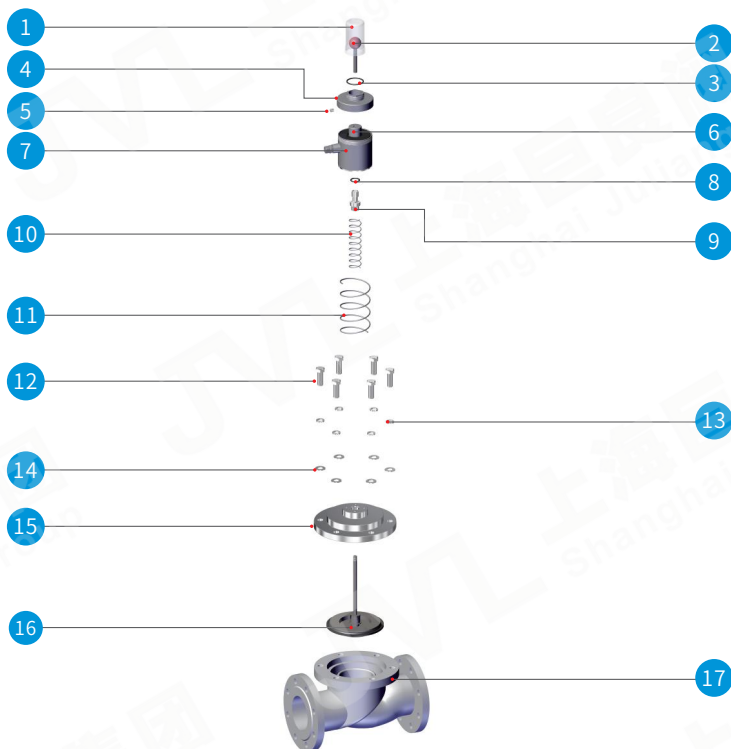
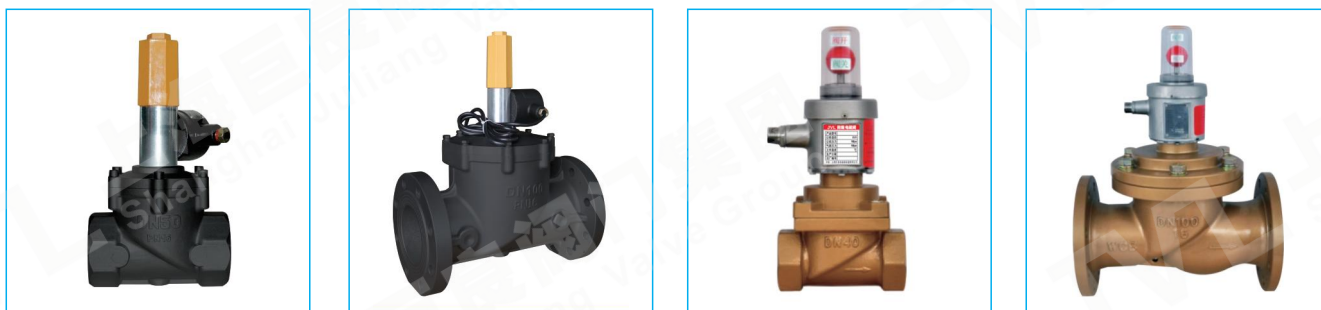

Part component description	
NO.	Name
1	Pull rod protective cover
2	Manual pull rod
3	Protective coverseal
4	Upper cover of electromagnetic coil
5	Lock bolt
6	Manual close button for the valve
7	Electromagnetic coil
8	Seal unit
9	Pull rod clamping device
10	Reset spring1
11	Reset spring2
12	Fasteing bolt of main valve
13	Spring washer
14	Flat washer
15	Main bonnet
16	Main valve diaphragm component
17	Valve body

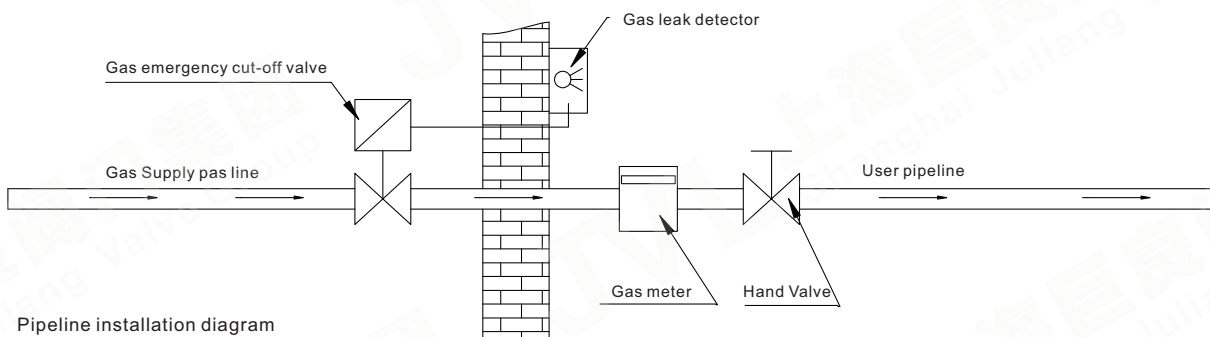

ZCK GAS EMERGENCY CUT-OFF SAFETY SOLENOID VALVE

(Manual open, energized valve off)

EXQUISITE TECHNIQUE/INSTANT POWER ON/QUICK CUT OFF/FLYING SAUCER PISTON

Application scope: gas emergency cut-off solenoid valve is a safety supporting device for gas pipeline engineering. It is widely used in combustible gas leakage monitoring instrument, central fire alarm system for high-rise buildings, gas supply pipe network system for cities or enterprises, thermal equipment, gas equipment, etc. Industrial kilns, boiler burners, thermal power plants, steel works and other pipe network safety system, to cut off flammable gas supply timely to prevent malignant events occurrence.

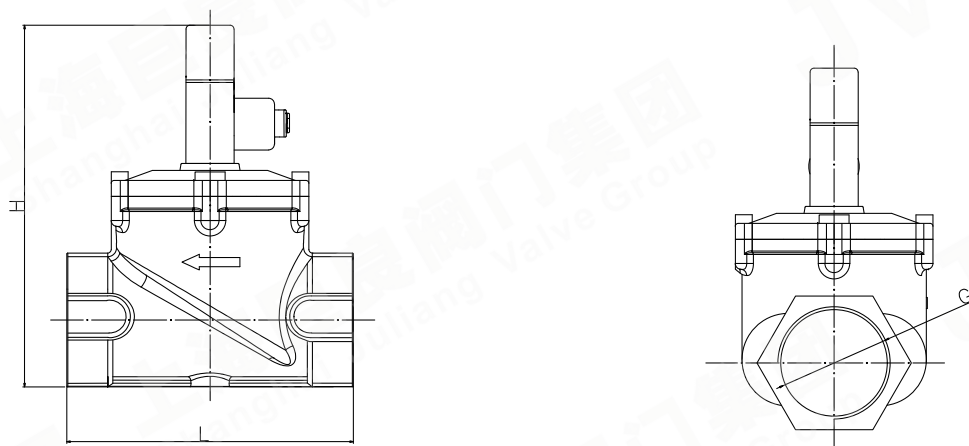

Thread connecting dimension(Figure 1)

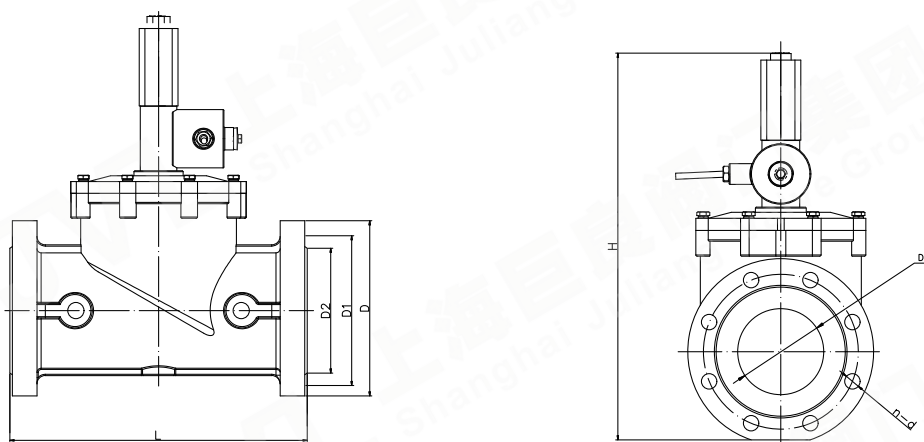

Flange connection dimension(Figure 2)

Aluminum alloy normally closed standard product specifications and dimensions

Type	Nominal diameter DN[mm]	Pipe thread [G]	Differential pressure range[bar]		Thread connection size			Flange connection size				
			AC	DC	L	H	D	D1	D2	N-φd	L	H
ZCK25-LG	25	G1"	0~6	0~6	100	235	100	85	65	4-φ14	150	265
ZCK32-LG	32	G1-1/4"	0~6	0~6	150	265	130	100	78	4-φ18	215	305
ZCK40-LG	40	G1-1/2"	0~6	0~6	150	265	140	110	85	4-φ18	215	305
ZCK50-LG	50	G2"	0~6	0~6	155	285	155	125	100	4-φ18	220	325
ZCK65-LG	65	-	0~6	0~6	-	-	175	145	120	4-φ18	280	400
ZCK80-LG	80	-	0~6	0~6	-	-	190	160	135	8-φ18	300	410
ZCK100-LG	100	-	0~6	0~6	-	-	210	180	155	8-φ18	355	460
ZCK125-LG	125	-	0~6	0~6	-	-	245	210	185	8-φ18	460	600
ZCK150-LG	150	-	0~6	0~6	-	-	280	240	210	8-φ23	480	650
ZCK200-LG	200	-	0~6	0~6	-	-	335	295	265	12-φ23	550	850

Valve size of pilot mode can be customized according to the actual situation of users, and please ask for the "overall drawing" from us

- Notes: 1.The above of technical data & mount size is standard design,if attach function option or pipe fit design strict, please ask us for "Outer size figure". Other grade pressure or specific requirement be subject to confirmed appointment or actual product.
- 2.When using anti-explosion situation,should asked us for anti-explosion "Outer size drawing"



GAS EMERGENCY CUT-OFF SAFETY SOLENOID VALVE

(Manual open, energized valve off)

ACCIDENT SELF-LOCKING/MANUAL RESET/ENERGY-SAVING/SAFE AND RELIABLE

Application scope: gas emergency cut-off solenoid valve is a safety supporting device for gas pipeline engineering. It is widely used in combustible gas leakage monitoring instrument, central fire alarm system for high-rise buildings, gas supply pipe network system for cities or enterprises, thermal equipment, gas equipment, etc. Industrial kilns, boiler burners, thermal power plants, steel works and other pipe network safety system, to cut off flammable gas supply timely to prevent malignant events occurrence.

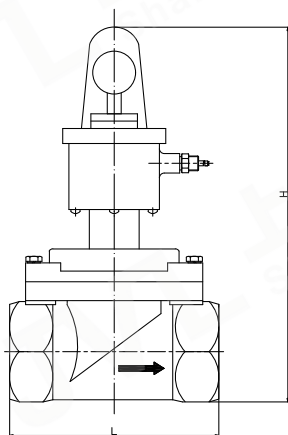

Thread connecting dimension(Figure 1)

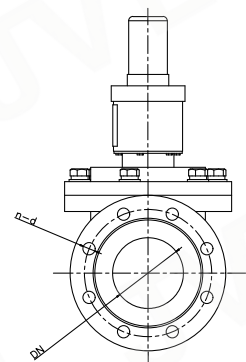
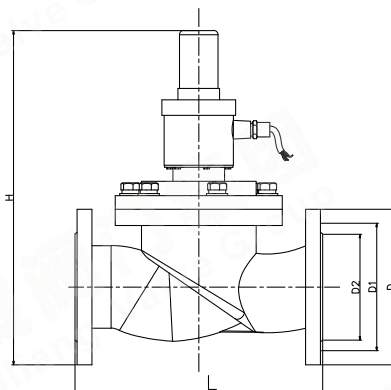
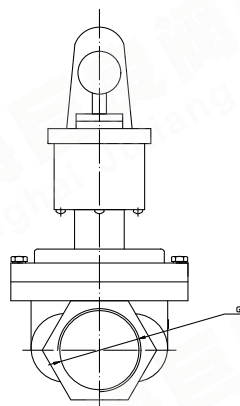

Flange connection dimension(Figure 2)

Normally closed standard product specifications & dimensions

Type	Nominal diameter DN[mm]	Pipe thread [G]	Differential pressure range[bar]		Thread connection size				Flange connection size			
			AC	DC	L	H	D	D1	D2	N-φd	L	H
ZCK15	15	G1/ 2"	0~6	0~6	100	210	95	65	45	4-φ14	130	240
ZCK20	20	G3/4"	0~6	0~6	100	230	105	75	55	4-φ14	150	270
ZCK25	25	G1"	0~6	0~6	100	230	115	85	65	4-φ14	160	285
ZCK32	32	G1-1/4"	0~6	0~6	130	265	135	100	78	4-φ18	180	300
ZCK40	40	G1-1/2"	0~6	0~6	130	285	145	110	85	4-φ18	200	310
ZCK50	50	G2"	0~6	0~6	150	300	160	125	100	4-φ18	230	325
ZCK65	64	-	0~6	0~6	-	-	180	145	120	4-φ18	290	400
ZCK80	80	-	0~6	0~6	-	-	195	160	135	8-φ18	310	435
ZCK100	100	-	0~6	0~6	-	-	215	180	155	8-φ18	350	460
ZCK125	125	-	0~6	0~6	-	-	245	210	185	8-φ18	400	580
ZCK150	150	-	0~6	0~6	-	-	280	240	210	8-φ18	480	600
ZCK200	200	-	0~6	0~6	-	-	335	295	265	12-φ22	600	650
ZCK250	250	-	0~6	0~6	-	-	405	355	320	12-φ26	650	900
ZCK300	300	-	0~6	0~6	-	-	460	410	370	12-φ26	750	1000
ZCK350	350	-	0~6	0~6	-	-	520	470	435	16-φ25	850	1080
ZCK400	400	-	0~6	0~6	-	-	580	525	480	16-φ30	950	1200
ZCK500	500	-	0~6	0~6	-	-	705	650	609	20-φ34	1150	1400
ZCK600	600	-	0~6	0~6	-	-	840	770	718	20-φ36	1350	1500

Valve size of pilot mode can be customized according to the actual situation of users, and please ask for the "overall drawing" from us

- Notes: 1. The above of technical data & mount size is standard design, if attach function option or pipe fit design strict, please ask us for "Outer size figure". Other grade pressure or specific requirement be subject to confirmed appointment or actual product.
- 2. When using anti-explosion situation, should asked us for anti-explosion "Outer size drawing"

Reserved space: in view of the operation and maintenance needs, the top of the solenoid valve space reserved height: ≤DN150 should be greater than 1 meter, ≥DN200 should be greater than 2 meters.